

23 OCT 2008



THE QUALITY FACTOR
BPW · THE QUALITY FACTOR
THE QUALITY FACTOR
FACTORY

1st Release – 23 October 2008

2nd Release – 2 October 2009



ECO^{Plus} 2

Repair kits and Information

New repair kits for ECO^{Plus} 2

The Next Generation



As of January 2008, BPW introduced the ECO^{Plus} 2 disc and drum braked axle into the market. Up to now it has only been introduced in conjunction with steering axles 2140 track to suit single wheels. The full introduction of ECO^{Plus} 2 is expected to begin in the first quarter of 2009.

Repair kits are now available for all the ECOPlus 2 axles already on our roads.

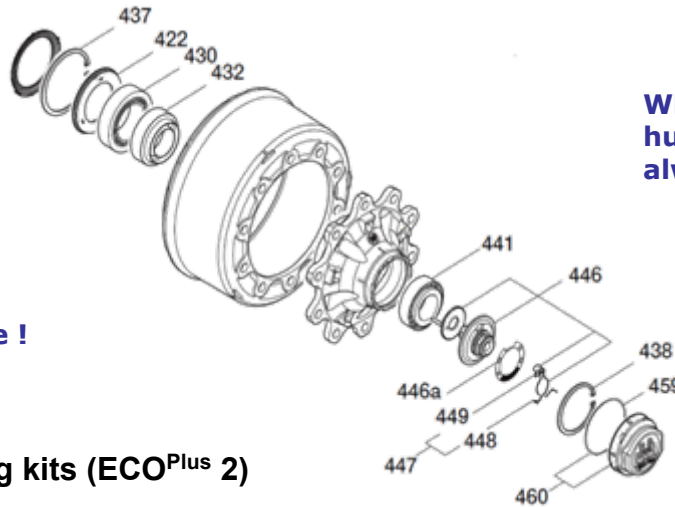

When assembling the hub cap on to the hub, always fit a new O-ring

Contents per axle side !

Tapered roller bearing kits (ECO^{Plus} 2)

Item	BPW Part number 09.801.07.33.0	Description	Quantity per Kit	Dimension
422	02.5664.74.00	ECO ^{Plus} seal	1	Ø 117.5 / 158 x 17.5
430	02.6410.23.00	Roller bearing	1	33118
432	03.120.47.08.0	Sealing ring (grease cartridge)	1	Ø 101 / 130 x 50
437	02.5606.58.90	Locking ring	1	Ø 158 x 4
438	02.5606.22.90	Locking ring	1	Ø 122 x 4
441	02.6410.22.00	Roller bearing	1	33213
446	09.001.37.03.0	Axle screw with toothed washer, incl. item 447	1	M 32 x 2 / SW 46
446a	02.0130.13.10	Paper disc - instruction	1	Do not use impact drivers!
447	05.188.03.10.0	Hooked spring ring, consists of item 448 + 449	1	
448	03.188.03.09.0	Hooked spring ring	1	
449	03.277.10.01.0	Locking piece	1	
459	02.5678.65.00	O-ring	1	Ø 128 x 3
460	05.212.25.78.0	Hubcap (bayonet lock), incl. item 459	1	Ø 137 / Ø 142.6 x 56.3

Repair kit 09.801.07.33.0 consists of item numbers 422 – 460 as per list above.

Repair kit 09.801.07.34.0 consists of item numbers 422, 430, 437, 438, 441 and 459

New repair kits for ECO^{Plus} 2 The Next Generation

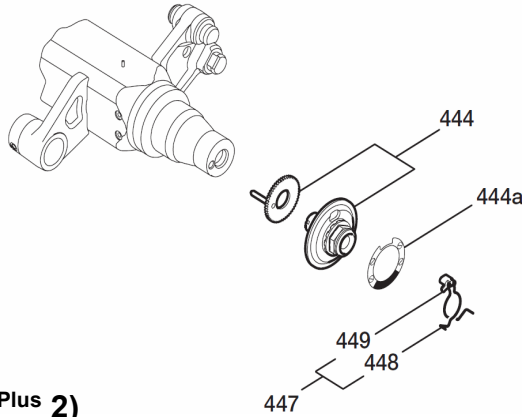

Contents per axle side !

Axle bolt repair kit (ECO^{Plus} 2)

Item	BPW Part number 09.001.37.03.0	Description	Quantity per Kit	Dimension
444	05.001.37.03.0	Axle screw with toothed washer	1	
444a	02.0130.13.10	Paper disc - instruction	1	Do not use impact drivers!
447	05.188.03.10.0	Hooked spring ring, consists of item 448 + 449	1	
448	03.188.03.09.0	Hooked spring ring	1	
449	03.277.10.01.0	Locking piece	1	

Repair kit 09.001.37.03.0 consists of item numbers 444 – 449 as per list above.

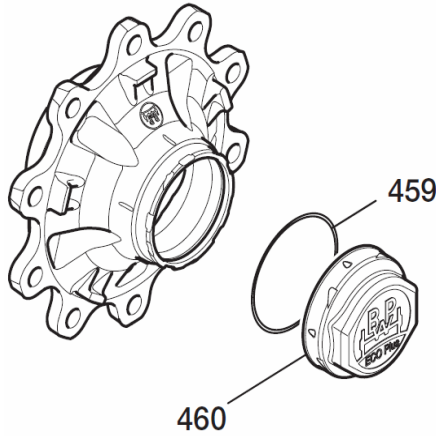

When assembling the hub cap on to the hub, always fit a new O-ring

Contents per axle side !

Hub cap repair kit (ECO^{Plus} 2)

Item	BPW Part number 05.212.25.78.0	Description	Quantity per Kit	Dimension
459	02.5678.65.00	O-ring	1	Ø 128 x 3
460	05.212.25.78.0	Hubcap (bayonet lock), incl. item 459	1	Ø 137 / Ø 142.6 x 56.3

Repair kit 05.212.25.78.0 consists of item numbers 449 – 460 as per list above.

New repair kits for ECO^{Plus} 2 The Next Generation

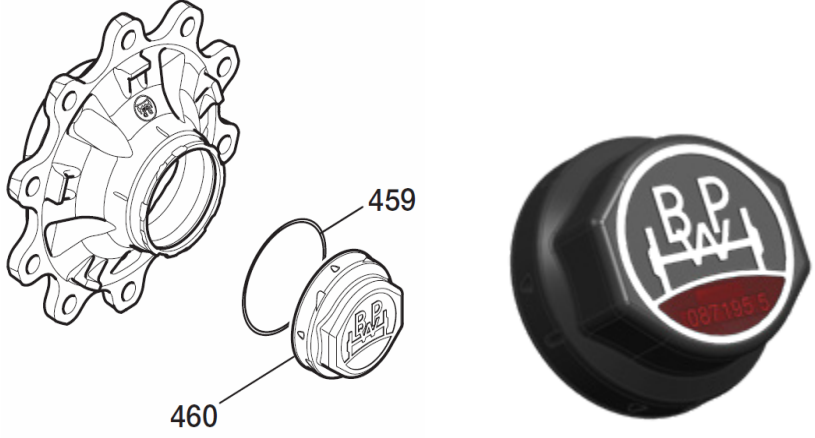

When assembling the hub cap on to the hub, always fit a new O-ring

When ordering, the tyre sizes are required for setting

Digital ECOMETER (ECO^{Plus} 2)

Item	BPW Part number 05.212.75.05.0	Description	Quantity per Kit	Dimension
459	02.5678.65.00	O-ring	1	Ø 128 x 3
460	05.212.75.05.0	Digital ECOMETER ECO ^{Plus} 2 incl. item 459	1	Bayonet lock

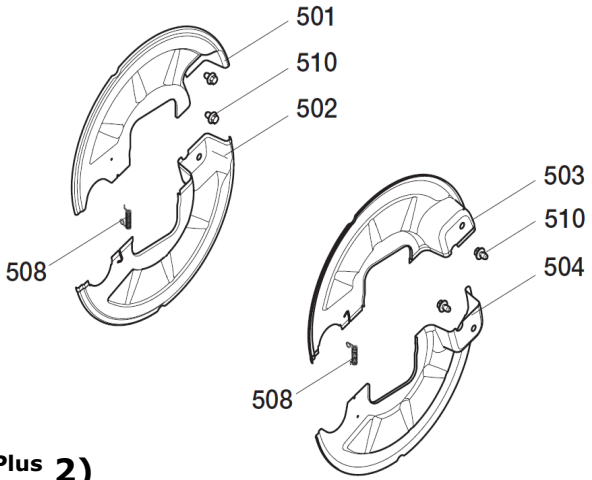

Dust covers are only supplied as a complete kit

Contents per axle !

Dust cover kit (ECO^{Plus} 2)

Item	BPW Part number 99.00.000.1.12	Description	Quantity per Kit	Dimension
501	03.010.91.96.0	Dust cover	1	
502	03.010.91.97.0	Dust cover	1	
503	03.010.91.94.0	Dust cover	1	
504	03.010.91.95.0	Dust cover	1	
508	03.397.11.02.0	Return spring for dust cover	1	
510	02.5071.55.80	Digital ECOMETER ECO ^{Plus} 2 incl. item 459	1	M 10 x 1.5 x 15 – 8.8

New repair kits for ECO^{Plus} 2 The Next Generation

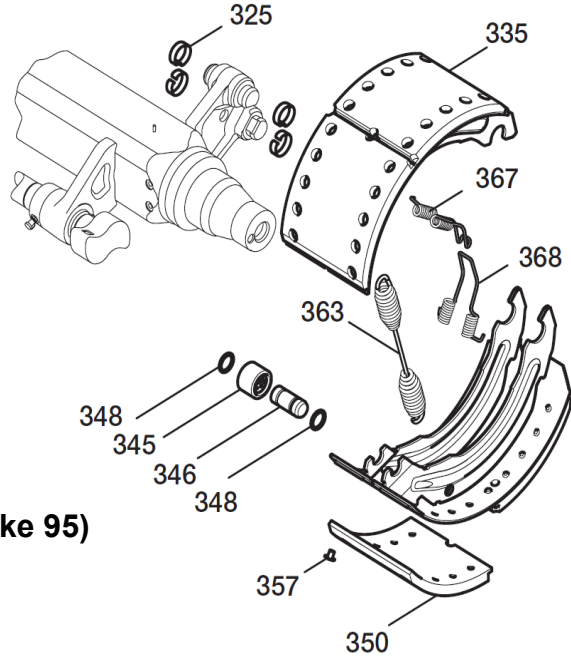

Brake shoe repair kit (Brake 95)

Contents per axle !

Item	BPW Part number 09.801.07.39.0	Description	Quantity per Kit	Dimension
329	09.801.06.79.0	SN 42.. brake repair kit (Return springs / hooked spring ring (C-clip) Consists of items 325, 363, 367,368	1	
330	05.091.46.32.1	Brake shoe group SN 4218, with lining Consists of items 335, 345 348, 350, 357	4	

Repair kit 09.801.07.39.0 consists of item numbers 329 and 330 as per list above.

Brake drums

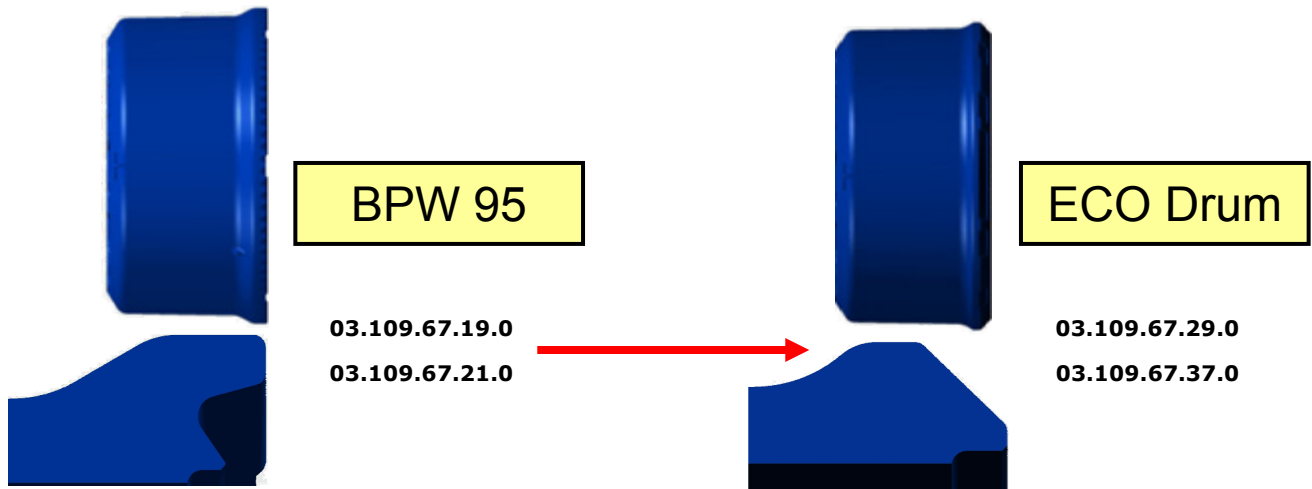

The ECO Drum is already available for axles with single wheels. The ECO Drum for dual wheels will be introduced in 2009. These drums will replace all existing versions of the 420 x 180 brake in 2009.

New repair kits for ECO^{Plus} 2 The Next Generation

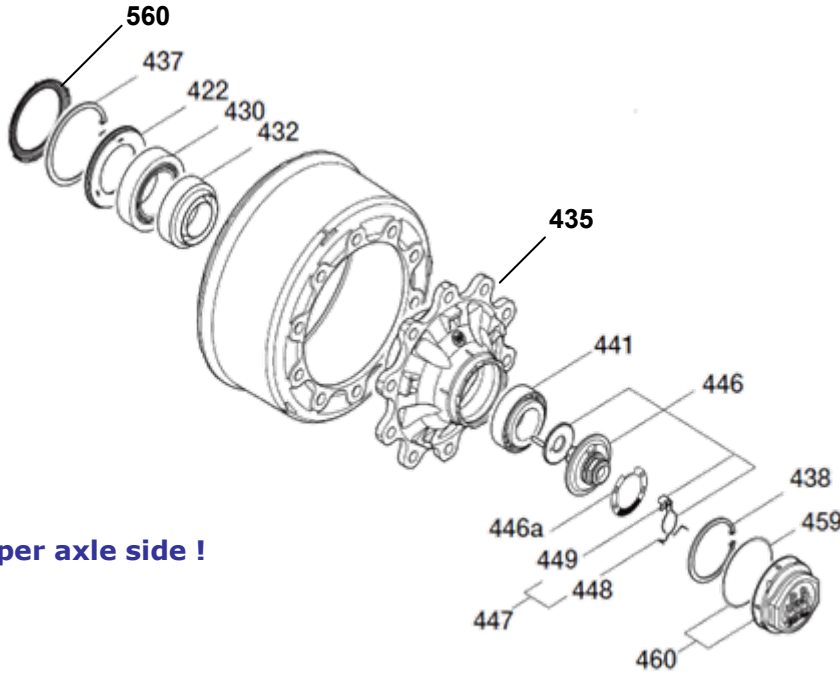

Contents per axle side !

Hub assembly ECO^{Plus} 2

Item	BPW Part number 09.801.07.35.0	Description	Quantity per Kit	Dimension
422	02.5664.74.00	ECO ^{Plus} seal	1	Ø 117.5 / 158 x 17.5
430	02.6410.23.00	Roller bearing	1	33118
432	03.120.47.08.0	Sealing ring (grease cartridge)	1	Ø 101 / 130 x 50
435	03.272.43.29.0	Hub - 9t ECO ^{Plus} 2	1	Short spigot 10 stud/ 335 pcd
437	02.5606.58.90	Locking ring	1	Ø 158 x 4
438	02.5606.22.90	Locking ring	1	Ø 122 x 4
441	02.6410.22.00	Roller bearing	1	33213
446	09.001.37.03.0	Axle screw with toothed washer, incl. item 447	1	M 32 x 2 / SW 46
446a	02.0130.13.10	Paper disc - instruction	1	Do not use impact drivers!
447	05.188.03.10.0	Hooked spring ring, consists of item 448 + 449	1	
448	03.188.03.09.0	Hooked spring ring	1	
449	03.277.10.01.0	Locking piece	1	
459	02.5678.65.00	O-ring	1	Ø 128 x 3
460	05.212.25.78.0	Hubcap (bayonet lock), incl. item 459	1	Ø 137 / Ø 142.6 x 56.3
560	03.310.08.51.0	ABS ring	1	125/165X8.5 - Z = 100

Hub assembly 09.801.07.35.0 consists of item numbers 422 – 560 as per list above.

ECO^{Plus} 2

The Next Generation



BPW ECO Drum - Your decisive advantage in the transport business!

BPW Bergische Achsen KG has occupied a leading position in drum brake technology for many years now, and has significantly extended its lead over the competition. Customers have bought more than 11 million drum brake axles from BPW, and they appreciate the proven technology, robust construction and straightforward maintenance of the BPW drum brake.

In a further development, the proven SN 4218 brake has now been improved again in terms of its weight, wearing properties and ease of service. The result of this development is called ECO Drum. ECO Drum axles contain proven BPW drum brake technology together with a reduction in weight. An optimised design means that the weight of the components for 9 t drum brake axles has been reduced by about 18 kg per axle with the ECO Drum SN 4218. For you, this weight reduction adds up to more payload!



The most striking feature of the ECO Drum brake is the new drum contour in the bead area as well as a new dust cover design. The newly designed observation holes in the dust covers mean that the wear edges of the brake lining and the brake drum can be checked easily. The improved seal between the dust cover and the brake drum reduces the amount of dirt entering the brake and therefore increases the service life of the brake components. The advantage for the user is obvious. Less complexity and therefore lower costs.

ECO^{Plus} 2 The Next Generation

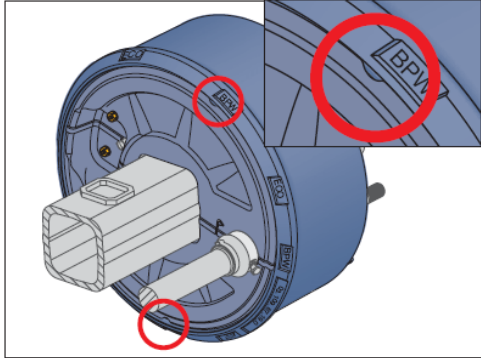

ECO Drum, lining observation holes

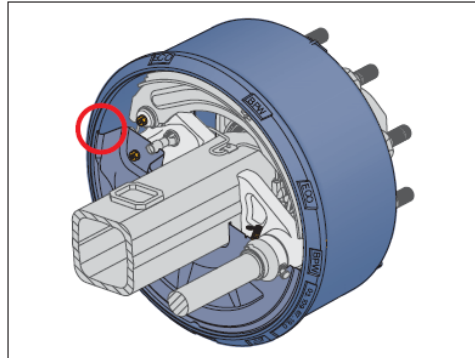

ECO Drum, dust cover seal

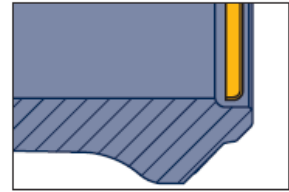

Sectional view:
ECO Drum axle
with new dust cover
contour

The quality of the dust cover attachment has been improved by using threaded bolts. This ensures that the dust cover can still be removed perfectly even after years of operation under the toughest conditions. The dust cover is quickly and easily inserted on the camshaft side and secured by a spring.

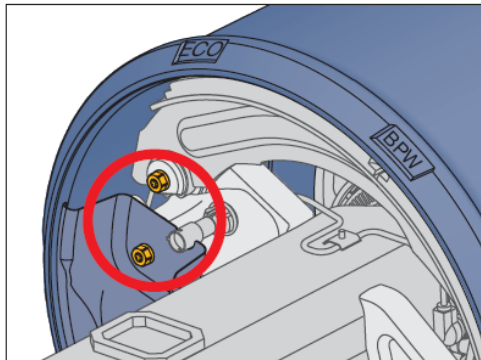

ECO Drum, threaded bolts

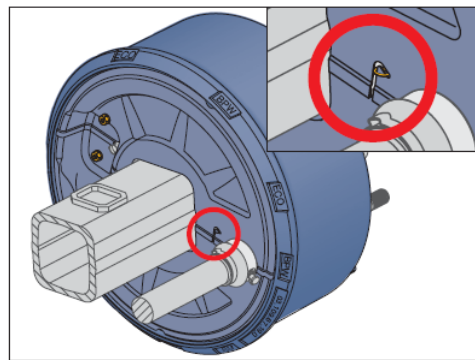

ECO Drum, spring holder

The advantages of the new ECO Drum are obvious: Greater payload, less wear and even easier servicing. These factors all add up to bigger profits for our customers.

Series launch

The ECO Drum is already available for axles with single wheels. The ECO Drum for dual wheels will be introduced in 2009. These drums will replace all existing versions of the 420 x 180 brake in 2009.

Brake certificate

No new homologations are required for the ECO Drum. The updated brake certificates for the ECO Drum SN 4218 can be found in the download centre on the BPW website at www.bpw.de using the familiar TDB numbers. The BPW ECO Drum axle can be installed in a vehicle together with the former drum brake axle.

ECOPlus 2 The Next Generation



Spare parts - compatibility

Only the new ECO Drum brake drums and the new brake shoes will be available as spares. The new brake drums and the new brake shoes can be used on the former drum brake axles without exchanging the dust cover.

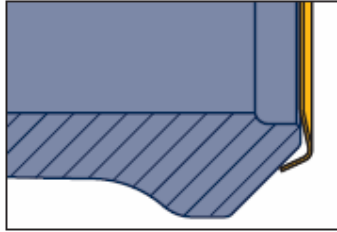
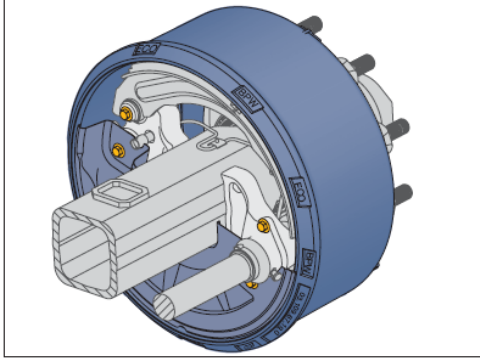

Sectional view:
Former ECOPlus axle
with dust cover and
new ECO Drum

Former ECOPlus axle with ECO Drum brake drum and ECO Drum brake shoes.

In addition, dust covers are available with the new external contour and the old brake anchor plate attachment. This means customers can benefit from the improved seal integrity between the new dust cover and brake drum design even when using the old type of drum brake axles.

Conversely, the former brake drums and the former brake shoes can also be used on the new ECO Drum, drum brake axles without exchanging the dust cover.

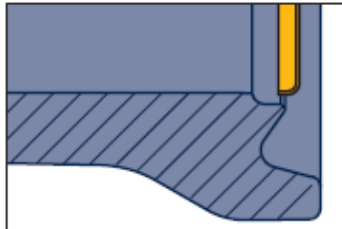
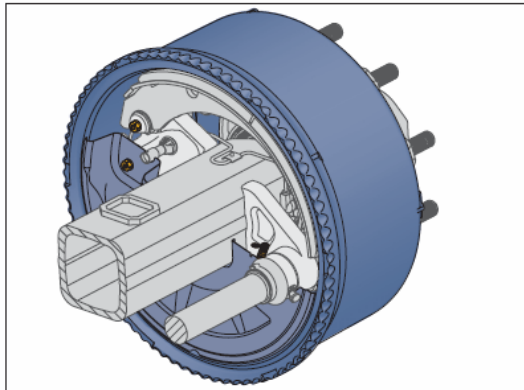

Sectional view:
New ECO Drum axle
with dust cover and former
ECOPlus drum or ECOPlus
brake shoes

New ECO Drum axle with ECOPlus brake drum and ECOPlus brake shoes.

Axles (up to 9 t axle load) in the ECOPlus series are being replaced by the ECO Plus 2 axle generation. When exchanging an ECOPlus axle beam for an ECOPlus 2 axle beam, it is therefore also necessary to exchange the toothed washer with pin, the axle bolt, the clasp locking ring with retaining key and the dust covers.

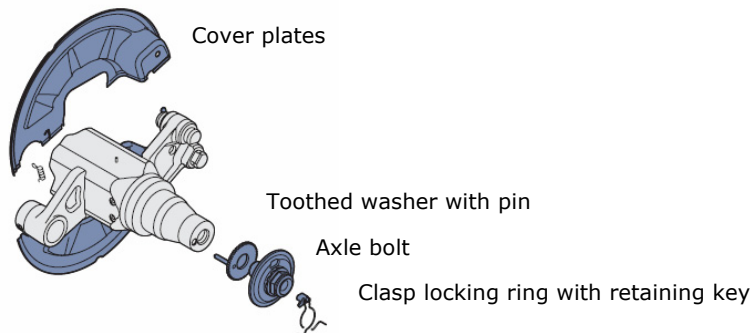

New repair kits for ECO^{Plus} 2 The Next Generation



Service Tools



Clockwise 30 degrees to secure
Anti clockwise 30 degrees to release

Hub cap spanner
03.339.05.02.0 SW120

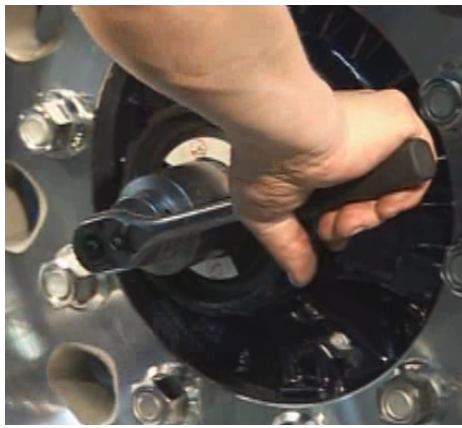

Axle nut size SW 46

Axle nut socket
SW46

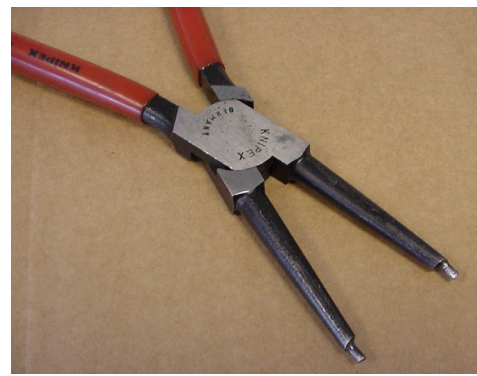
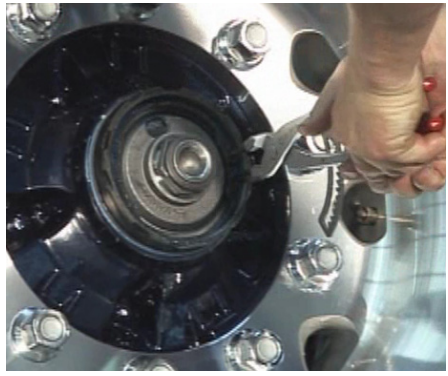

Circlip pliers